



37 Checkley Road

ST5 7TN

Asking Price £290,000



4



2



2



STEPHENSON BROWNE

This detached four-bedroom family home with a driveway providing parking for up to three cars, a garage, and a layout that's both spacious and practical.

While the property needs updating and some work, it already offers an excellent foundation for comfortable living. The ground floor begins with a large entrance hall, complete with a cloakroom/storage room, WC, and internal access to the garage.

To the rear sits a well-sized kitchen with French doors leading out to the enclosed garden, alongside a generous living room with a feature fireplace as its focal point and at the front of the property is a separate dining room perfect for family meals or entertaining .

Upstairs, bedroom one includes a handy airing cupboard, while bedroom two not only benefits from its own en-suite but also features a useful wardrobe area. Two further good-sized bedrooms, a family bathroom, and a boiler room providing extra storage complete the accommodation.

Outside, the rear garden is safe and private, while to the front the driveway provides ample parking. The property's standout feature is its enviable position beside a walkway that leads directly to open fields, perfect for dog walking, family strolls, or simply enjoying the outdoors.

With schools, shops, and excellent transport links nearby, this detached home offers space, convenience, and charm, ready to be shaped into a wonderful long-term family residence.

Council Borough: Newcastle-under-Lyme
Council Tax Band: C
Tenure: Freehold



Ground Floor

Hallway

6'10" x 17'5"

Dining Room

8'4" x 10'10"

Living Room

13'1" x 11'10"

W.C.

3'1" x 5'8"

Kitchen

9'2" x 13'1"

Storage Room

4'1" x 4'0"

Garage

8'1" x 13'7"

First Floor

Bedroom One/Study

6'6" x 8'11"

Bedroom Two (Master Bedroom)

12'2" x 11'8"

Ensuite

4'10" x 6'7"

Bedroom Three

9'8" x 10'5"

Bedroom Four

10'8" x 9'8"

Family Bathroom

7'7" x 5'1"

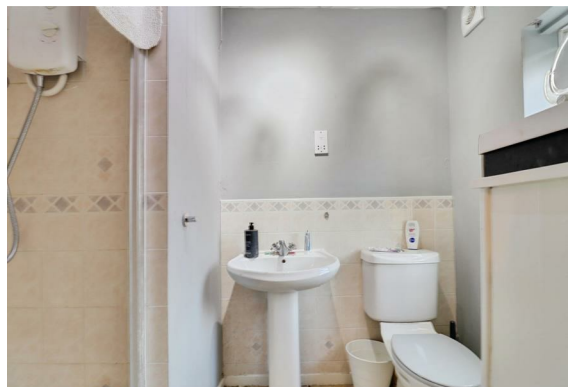

- Spacious detached family home with generous living space
- Four well-proportioned bedrooms, one featuring an en-suite
- Two bright reception rooms ideal for family gatherings
- Modern kitchen with contemporary fittings
- Private rear garden for outdoor entertaining
- Integral garage and driveway providing secure parking
- Downstairs W.C. and separate cloakroom
- Needs updating but offers excellent potential
- Great family home with close proximity to schools, shops, and transport links



Floor Plan

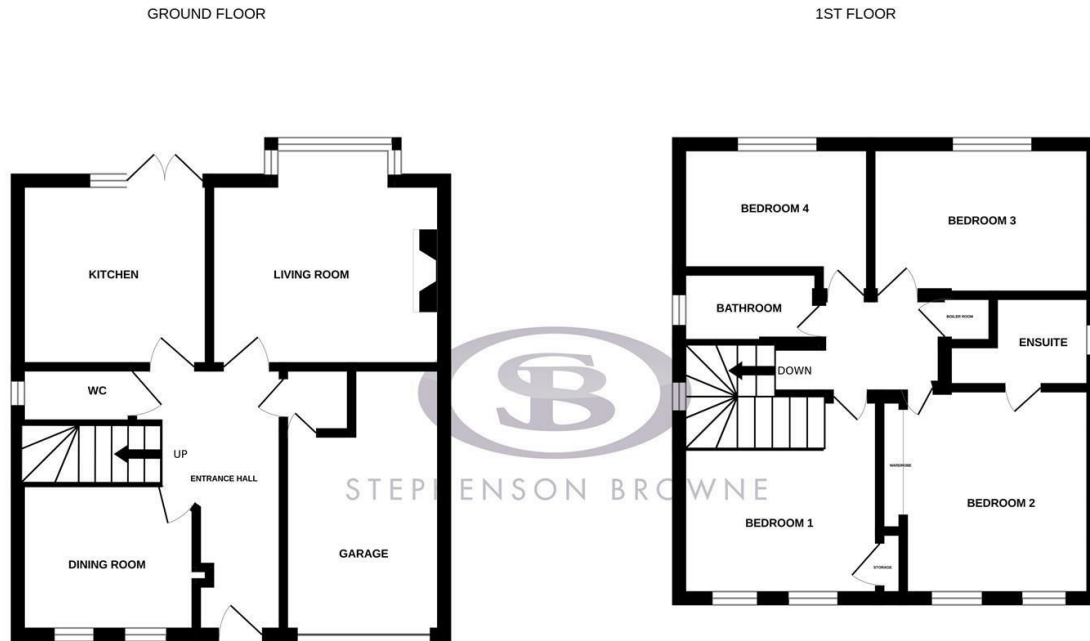

Whilst every attempt has been made to ensure the accuracy of the floorplan contained here, measurements of doors, windows, rooms and any other items are approximate and no responsibility is taken for any error, omission or mis-statement. This plan is for illustrative purposes only and should be used as such by any prospective purchaser. The services, systems and appliances shown have not been tested and no guarantee as to their operability or efficiency can be given.
 Made with Metropix ©2025

Area Map



Energy Efficiency Rating		Current	Potential
Very energy efficient - lower running costs			
(92 plus) A			
(81-91) B			
(69-80) C			
(55-68) D			
(39-54) E			
(21-38) F			
(1-20) G			
Not energy efficient - higher running costs			
England & Wales	EU Directive 2002/91/EC		

Environmental Impact (CO ₂) Rating		Current	Potential
Very environmentally friendly - lower CO ₂ emissions			
(92 plus) A			
(81-91) B			
(69-80) C			
(55-68) D			
(39-54) E			
(21-38) F			
(1-20) G			
Not environmentally friendly - higher CO ₂ emissions			
England & Wales	EU Directive 2002/91/EC		

Viewing

Please contact our Newcastle Office on 01782 625734 if you wish to arrange a viewing appointment or require further information.

NOTICE: Stephenson Browne for themselves and for the vendors or lessors of this property whose agents they are give note that: (1) the particulars are set out as a general guideline only for the guidance of intending purchasers or lessees. and do not constitute, nor constitute part of, an offer or contract; (2) all descriptions, dimensions, references to condition and necessary permissions for use and occupation, and other details are given in good faith and are believed to be correct but any intending purchasers or tenants should not rely on them as statements or representations of fact but must satisfy themselves by inspection or otherwise as to be the correctness of each theme; (3) no person in the employment of Stephenson Browne has any authority to make representation or warranty in relation to this property; (4) fixtures and fittings are subject to a formal list supplied by the vendors solicitor. Referring to: Move with Us Ltd Average fee: £123.64

56 Merial Street, Newcastle Under Lyme, Staffordshire, ST5 2AW
 Telephone: 01782 625734 Email: sandbach@stephensonbrowne.co.uk Website: www.stephensonbrowne.co.uk